

ELEVATION

VELUX Skylights installed in new metal roofing

1. The sheets are fitted 100 mm from the bottom frame
2. The flashing is mounted
3. Fit the metal sheets
4. Skylights must be spaced 100mm apart for EKW centre channel to fit

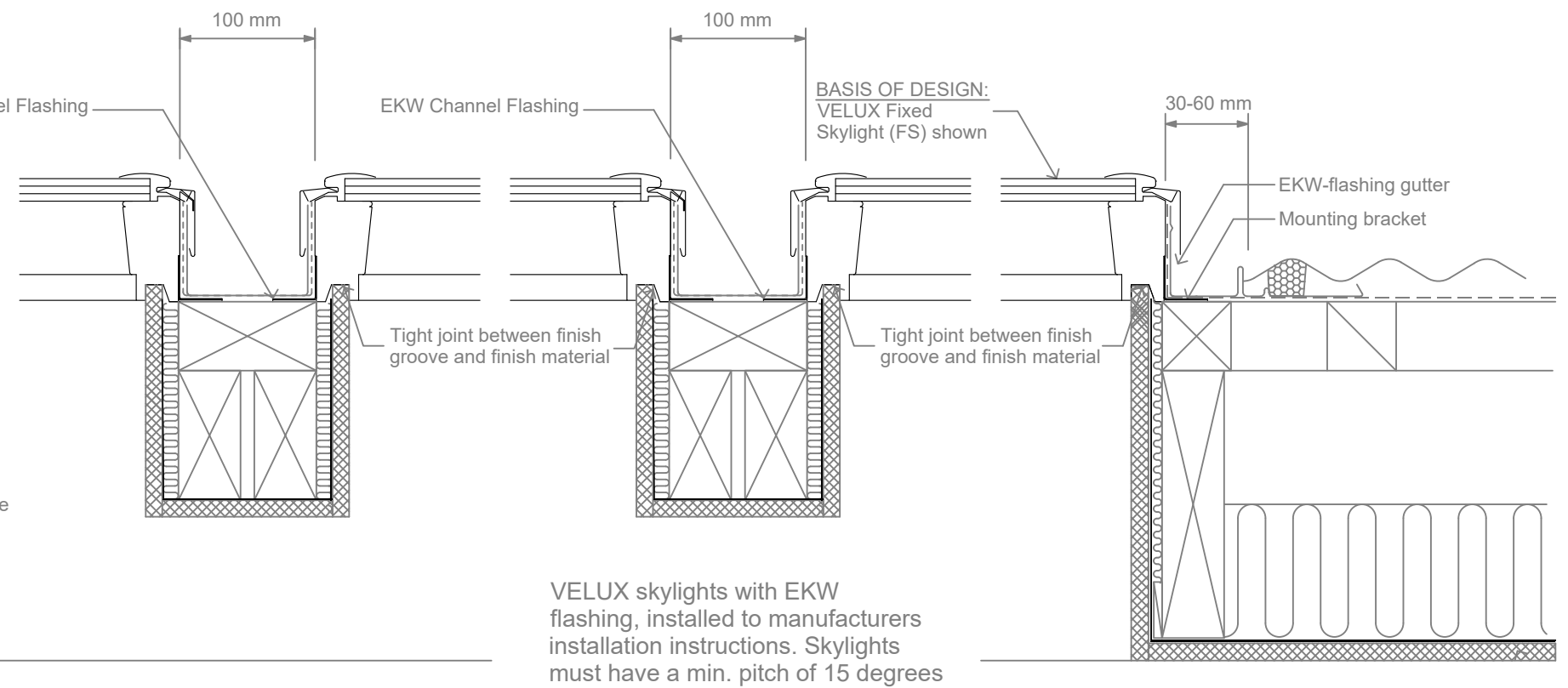

VELUX skylights with EKW flashing, installed to manufacturers installation instructions. Skylights must have a min. pitch of 15 degrees

Multiple VELUX Skylights Side-by-sideand EKW Combi Flashing in Corrugated Metal Roof

NEW ZEALAND LTD.

0800 650 445

Drawn by	Name	Date
Checked by		Jan 18
Drawing No.		Jan 18